

Clinton Park Plan

Neighborhood Park Redesign

East Bay Asian Local Development Corporation
 Eastlake Merchants Association
 Urban Ecology

The Eastlake neighborhood is one of Oakland's most diverse communities, and is home to recent immigrants from Southeast Asia, African-Americans, Latinos, and Native Americans. In 1997, the Eastlake Merchants Association (ELMA) identified Clinton Park, a one-square mile park on International Boulevard, as a priority for revitalization. The park suffered from poor maintenance and a perception as a place for crime and illegal activity--and so even on warm, sunny days, one could find the park nearly empty.

With input from residents, local merchants, community groups, and East Bay Asian Local Development Corporation (EBALDC), Urban Ecology created a park design with social, environmental, and economic goals, and one that reflects the neighborhood's commonalities and its diversity. The project will restore the small natural oasis and return it to the people of the neighborhood.

- Enhance the environmental quality of the park and neighborhood
- Celebrate the community's multicultural heritage and identity
- Create a setting for social interaction
- Provide children's play facilities
- Increase safety by reducing the speed of traffic along streets bordering the park
- Use the park rehabilitation as a tool to attract and revitalize local small businesses

When rehabilitated and maintained, Clinton Park will once again be a source of neighborhood pride and a center for community activities, reflecting the ethnic groups that give Eastlake its character. Incremental public improvements are intended to act as a catalyst for community development. EBALDC and ELMA are currently undertaking the park improvements.



Children's play space and picnic area.



Conceptual site plan.

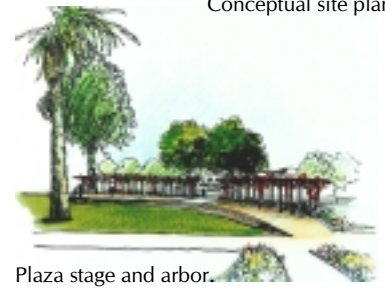

Plaza stage and arbor.



Storytelling tree.



Community center.